

1371 Crescent Ave

MANTECA, CA 95336



PRICE
\$510,000

PLAN
Residence 2

LOCATION
Dawn at The Collective 55+

FEATURES

-  2 Bedrooms
-  2 Ba, 1 Half Ba
-  2,314 Sq. Ft.
-  2 Car Garage

Homesite 281 at Dawn at The Collective by Trumark Homes is a flexible single-story home offering 2,314 sq. ft. of thoughtfully designed living space with two bedrooms and two and a half bathrooms, move-in ready by early summer 2026. The first floor features a guest suite with a full bathroom and an impressive walk-in closet, ideal for visitors or multigenerational living, along with a well-appointed den, hall powder room, and conveniently located laundry room. Past the entryway, the gourmet kitchen includes recessed-panel Beech Shaker cabinetry with stained finishes, chrome knobs, granite slab countertops with a 6" backsplash, stainless steel appliances, a center preparation island, and a spacious walk-in pantry. The luxurious primary suite offers a spa-like bathroom with dual sinks, a walk-in shower, a spacious bathtub, and an expansive walk-in closet. There is still time to personalize interior finishes to make this home uniquely yours. Located in a gated community with a 10,000 sq. ft. clubhouse featuring a pool, fitness center, pickleball and bocce courts, a dog park with wash station, and more, this neighborhood offers the perfect blend of active, resort-style living. Schedule a tour today to make this home yours!

Representative photos added.

DAWN AT THE COLLECTIVE | RESIDENCE 2 FLOOR PLAN

Dawn | RESIDENCE 1
AT THE COLLECTIVE | 2 Bedrooms, 2.5 Baths, 2,021 Sq. Ft.

THE COLLECTIVE
TRULIVING MANTECA



IAR - Contemporary Farmhouse



IBR - Napa Valley Classic



ICR - Craftsman



ELEVATION 1CR



OPTIONAL COVERED
OUTDOOR ROOM

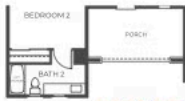

ELEVATION IAR



ELEVATION IBR

New Home Specialist • (925) 281-3227 • Sales@TrumarkHomes.com

Dawn Sales Gallery • 1306 Parkcrest Circle, Manteca, CA 95336 • VIP-Dawn.com

This is not an offer to sell but is intended for information only. The developer reserves the right to make modifications to materials, specifications, plans, pricing, various fees, designs, scheduling and delivery of homes without prior notice. Square footage is approximate. Floor plans are for representational purposes only. Plans and dimensions may contain minor variations from floor to floor. Renderings are artist's conceptions and do not depict actual homesites. CA CRE license #0187729, 8/2022.

PRELIMINARY AND SUBJECT TO CHANGE

TRUMARKHOMES