

5851 Kilbeggin Road

TIMNATH, CO 80547



PRICE

\$855,239

PLAN

Plan 2

LOCATION

Kitchel Lake

FEATURES

-  3 Bedrooms
-  2.5 Bathrooms
-  2,228 Sq. Ft.
-  3 Car Garage

Homesite 7, a plan 2 at Kitchel Lake, is a contemporary single-story home with an oversized 3-car garage offering 2,228 Sq. Ft. of living space with three bedrooms and two and a half baths. The home features an inviting porch with secondary bedrooms and an office just through the entrance hall. Beyond is the gourmet kitchen featuring a spacious walk-in pantry and a center preparation island. This island includes dual sinks and overlooks the dining and great rooms, complete with a gas fireplace. The extended kitchen includes 42" deluxe Dusk Matte cabinetry, brushed nickel fixtures, light quartz countertops with tile backsplash, stainless steel appliance package with a 5-burner gas cooktop, a convection oven, a built-in microwave, and a dishwasher.

The great room opens up to the covered outdoor room. The primary suite, located just off the great room offers a stunning, spa-like bathroom with a walk-in shower. An expansive walk-in closet completes the primary suite.

The home comes with extensive 5" plank engineered hardwood flooring in the entry and kitchen, luxurious carpet in bedrooms, deluxe primary shower tile with mosaic tile shower pan, spacious 9 and 10-foot ceilings, insulated steel garage door, tankless water heater and AC, and much more!

5851 Kilbeggin Road

TIMNATH, CO 80547

KITCHEL LAKE PLAN 2 FLOOR PLAN



PLAN 2

3 - 4 Bedrooms · 2.5 - 3.5 Baths · 3-Car Garage
Approx. 2,228 - 3,184 Finished Sq. Ft.

PRELIMINARY



Elevation 2A - Modern Farmhouse



Elevation 2B - Modern Prairie



Elevation 2C - Modern Mountain



All information is for reference only. Prices, taxes and specifications subject to change and should be verified by all potential homebuyers. This is not an offer to sell but is intended for information only. The developer reserves the right to make modifications in materials, specifications, plans, pricing, various fees, designs, scheduling and delivery of homes without prior notice. All dimensions and square footages are approximate. Plan and dimensions may contain minor variations from floor to floor. CA DRE license no. 01877720. (i)

VIP-KITCHEL.COM



5851 Kilbeggin Road

TIMNATH, CO 80547

KITCHEL LAKE PLAN 2 FLOOR PLAN



PLAN 2

3 - 4 Bedrooms · 2.5 - 3.5 Baths · 3-Car Garage
Approx. 2,228 - 3,184 Finished Sq. Ft.

PRELIMINARY



FIRST FLOOR

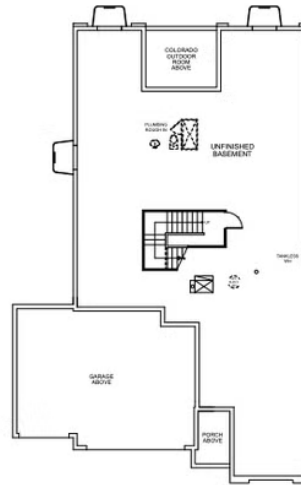

BASEMENT



All information is for reference only. Prices, taxes and specifications subject to change and should be verified by all potential homebuyers. This is not an offer to sell but is intended for information only. The developer reserves the right to make modifications in materials, specifications, plans, pricing, various fees, designs, scheduling and delivery of homes without prior notice. All dimensions and square footages are approximate. Plan and dimensions may contain minor variations from floor to floor. CA DRE license no. 01877720. ©

VIP-KITCHEL.COM

5851 Kilbeggin Road

TIMNATH, CO 80547

KITCHEL LAKE PLAN 2 FLOOR PLAN



PLAN 2 - OPTIONS

3 - 4 Bedrooms • 2.5 - 3.5 Baths • 3-Car Garage
Approx. 2,228 - 3,184 Finished Sq. Ft.

PRELIMINARY



FIRST FLOOR



BASEMENT



All information is for reference only. Prices, taxes and specifications subject to change and should be verified by all potential homebuyers. This is not an offer to sell but is intended for information only. The developer reserves the right to make modifications in materials, specifications, plans, pricing, various fees, designs, scheduling and delivery of homes without prior notice. All dimensions and square footages are approximate. Plan and dimensions may contain minor variations from floor to floor. CA DRE license no. 01877720. (d)

VIP-KITCHEL.COM

TRUMARKHOMES

5851 Kilbeggin Road

TIMNATH, CO 80547

GET IN TOUCH
(970) 499-8222

KITCHEL LAKE PLAN 2 FLOOR PLAN



TRUMARKHOMES

5851 Kilbeggin Road

TIMNATH, CO 80547

GET IN TOUCH
(970) 499-8222

KITCHEL LAKE PLAN 2 FLOOR PLAN

