

8741 Whiteclover Street

LITTLETON, CO 80125



PRICE
\$629,900

PLAN
Plan 2

LOCATION
Duet at Sterling Ranch

FEATURES

-  3 Bedrooms
-  2 Ba, 1 Half Ba
-  1,882 Sq. Ft.
-  2 Car Garage

Welcome to homesite 111 of the Duet Collection at Sterling Ranch, a spacious Plan 2 duplex offering approximately 1,882 finished square feet of thoughtfully designed living space. This inviting floorplan features a large dining room, a covered outdoor room, and an in-ground unfinished basement, creating a seamless blend of comfort and functionality. Modern living and lifestyle come together in perfect harmony with a professionally designed finish package that includes LVP wood-look flooring, a tankless water heater, a gas line to the range, air conditioning, and more.

This home showcases a Colorado Farmhouse elevation and includes 3 bedrooms and 2.5 bathrooms, along with a convenient main-floor pocket office and an upstairs loft for additional flexible space. The kitchen is designed with white cabinetry, quartz countertops, and a GE Café gourmet appliance package, making it ideal for both everyday living and entertaining. The unfinished basement offers additional potential with rough-in plumbing for a future bathroom. Additional highlights include a covered outdoor room just off the dining area, a two-car garage with an 8-foot garage door, and the Christy Plus design finish package. The homesite also fronts open space and is located near a charming pocket park, offering scenic surroundings and easy access to outdoor enjoyment.

8741 Whiteclover Street

LITTLETON, CO 80125

DUETS AT STERLING RANCH BY TRUMARK HOMES | PLAN 2

DUETS COLLECTION

RESIDENCE 2

3 Bedrooms · 2.5 Baths · Loft · 2-Car Garage
Approx. 1,882 Sq. Ft.



STERLING RANCH™
COLORADO

PRELIMINARY

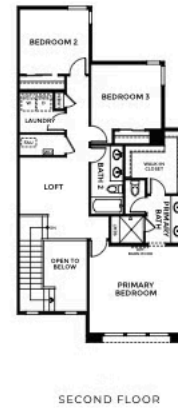

Preliminary and subject to change. 720.802.6221 | SterlingRanchSales@trumarkco.com | 7046 Watercress Drive, Littleton CO | VIP-STERLINGRANCH.COM

TRUMARKHOMES All information is for reference only. Prices, taxes and specifications subject to change and should be verified by all potential homebuyers. This is not an offer to sell but is intended for information only. The developer reserves the right to make modifications in materials, specifications, plans, pricing, various fees, designs, scheduling and delivery of homes without prior notice. All dimensions and square footages are approximate. Plan and dimensions may contain minor variations from floor to floor. Updated 05/30/2024. ©

8741 Whiteclover Street

LITTLETON, CO 80125

DUETS AT STERLING RANCH BY TRUMARK HOMES | PLAN 2

DUETS COLLECTION

RESIDENCE 2 - ELEVATIONS

3 Bedrooms · 2.5 Baths · Loft · 2-Car Garage
Approx. 1,882 Sq. Ft.



STERLING RANCH™
COLORADO

PRELIMINARY



FIRST FLOOR - HIGH COUNTRY RANCH



SECOND FLOOR - HIGH COUNTRY RANCH

Preliminary and subject to change. 720.802.6221 | SterlingRanchSales@trumarkco.com | 7046 Watercress Drive, Littleton CO | VIP-STERLINGRANCH.COM

TRUMARKHOMES All information is for reference only. Prices, rates and specifications subject to change and should be verified by all potential homebuyers. This is not an offer to sell but is intended for information only. The developer reserves the right to make modifications in materials, specifications, plans, pricing, various fees, designs, scheduling and delivery of homes without prior notice. All dimensions and square footages are approximate. Plan and dimensions may contain minor variations from floor to floor. Updated 05/30/2024. ©

8741 Whiteclover Street

LITTLETON, CO 80125

DUETS AT STERLING RANCH BY TRUMARK HOMES | PLAN 2

DUETS COLLECTION

RESIDENCE 2 - ELEVATIONS

3 Bedrooms · 2.5 Baths · Loft · 2-Car Garage
Approx. 1,882 Sq. Ft.



STERLING RANCH™
COLORADO

PRELIMINARY



FIRST FLOOR - COLORADO PRAIRIE



SECOND FLOOR - COLORADO PRAIRIE

Preliminary and subject to change. 720.802.6221 | SterlingRanchSales@trumarkco.com | 7046 Watercress Drive, Littleton CO | VIP-STERLINGRANCH.COM

TRUMARKHOMES All information is for reference only. Prices, rates and specifications subject to change and should be verified by all potential homebuyers. This is not an offer to sell but is intended for information only. The developer reserves the right to make modifications in materials, specifications, plans, pricing, various fees, designs, scheduling and delivery of homes without prior notice. All dimensions and square footages are approximate. Plan and dimensions may contain minor variations from floor to floor. Updated 05/30/2024. ©

TRUMARK**HOMES**

8741 Whiteclover Street

LITTLETON, CO 80125

GET IN TOUCH
(720) 704-1472

DUETS AT STERLING RANCH BY TRUMARK HOMES | PLAN 2



TRUMARKHOMES

8741 Whiteclover Street

LITTLETON, CO 80125

GET IN TOUCH
(720) 704-1472

DUETS AT STERLING RANCH BY TRUMARK HOMES | PLAN 2

