

8729 Whiteclover Street

LITTLETON, CO 80125



PRICE

\$649,900

PLAN

Plan 2

LOCATION

Duet at Sterling Ranch

FEATURES

-  3 Bedrooms
-  2 Ba, 1 Half Ba
-  1,882 Sq. Ft.
-  2 Car Garage

Welcome to homesite 105 of the Duet Collection at Sterling Ranch. This spacious duplex home offers approximately 1,882 finished sq. ft. of living space. The thoughtfully designed floorplan includes a main floor pocket office, an upstairs loft, and an in-ground unfinished basement. With the Jocelyn I design finish package, this home blends modern living and lifestyle through features such as LVP wood-like flooring, a tankless water heater, gas line to range, air conditioning, and more.

The High Country Ranch elevation style adds charm and curb appeal, while the interior is designed for functionality and comfort. The kitchen showcases white cabinets, quartz countertops, and KitchenAid appliances, flowing seamlessly into the dining and great room. Just off the kitchen-dining area, a covered outdoor room provides the perfect spot to enjoy indoor-outdoor living.

Key features include 3 bedrooms, 2.5 bathrooms, a main floor pocket office, and an upstairs loft. The unfinished basement provides ample space for storage or future expansion. An oversized garage with an 8' door and opener adds convenience, while the home's location fronts to open space and nearby parks, offering both privacy and community connection.

8729 Whiteclover Street

LITTLETON, CO 80125

DUETS AT STERLING RANCH BY TRUMARK HOMES | PLAN 2

**DUETS
COLLECTION**

RESIDENCE 2

3 Bedrooms · 2.5 Baths · Loft · 2-Car Garage
Approx. 1,882 Sq. Ft.



STERLING RANCH™
COLORADO

PRELIMINARY

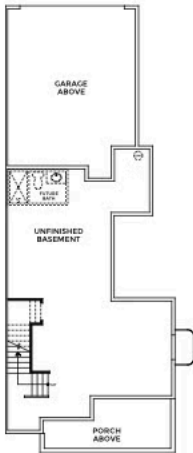

UNFINISHED BASEMENT



FIRST FLOOR



SECOND FLOOR

Preliminary and subject to change. 720.802.6221 | SterlingRanchSales@trumarkco.com | 7046 Watercress Drive, Littleton CO | VIP-STERLINGRANCH.COM
All information is for reference only. Prices, taxes and specifications subject to change and should be verified by all potential homebuyers. This is not an offer to sell but is intended for information only. The developer reserves the right to make modifications to materials, specifications, plans, pricing, various fees, designs, scheduling and delivery of homes without prior notice. All dimensions and square footages are approximate. Plan and dimensions may contain minor variations from floor to floor. Updated 05/30/2024. (B)

TRUMARKHOMES

8729 Whiteclover Street

LITTLETON, CO 80125

DUETS AT STERLING RANCH BY TRUMARK HOMES | PLAN 2

DUETS
COLLECTION

RESIDENCE 2 - ELEVATIONS
3 Bedrooms · 2.5 Baths · Loft · 2-Car Garage
Approx. 1,882 Sq. Ft.

STERLING RANCH™
COLORADO

PRELIMINARY



Preliminary and subject to change. 720.802.6221 | SterlingRanchSales@trumarkco.com | 7046 Watercress Drive, Littleton CO | VIP-STERLINGRANCH.COM

TRUMARKHOMES All information is for reference only. Prices, taxes and specifications subject to change and should be verified by all potential homebuyers. This is not an offer to sell but is intended for information only. The developer reserves the right to make modifications to materials, specifications, plans, pricing, various fees, designs, scheduling and delivery of homes without prior notice. All dimensions and square footages are approximate. Plan and dimensions may contain minor variations from floor to floor. Updated 05/30/2024. ©

DUETS AT STERLING RANCH BY TRUMARK HOMES | PLAN 2

DUETS
COLLECTION

RESIDENCE 2 - ELEVATIONS

3 Bedrooms · 2.5 Baths · Loft · 2-Car Garage
Approx. 1,882 Sq. Ft.



STERLING RANCH™
COLORADO

PRELIMINARY



Preliminary and subject to change. 720.802.6221 | SterlingRanchSales@trumarkco.com | 7046 Watercress Drive, Littleton CO | VIP-STERLINGRANCH.COM

TRUMARKHOMES All information is for reference only. Prices, taxes and specifications subject to change and should be verified by all potential homebuyers. This is not an offer to sell but is intended for information only. The developer reserves the right to make modifications to materials, specifications, plans, pricing, various fees, designs, scheduling and delivery of homes without prior notice. All dimensions and square footages are approximate. Plan and dimensions may contain minor variations from floor to floor. Updated 05/30/2024. (B)

TRUMARKHOMES

8729 Whiteclover Street

LITTLETON, CO 80125

GET IN TOUCH
(720) 704-1472

DUETS AT STERLING RANCH BY TRUMARK HOMES | PLAN 2



TRUMARK**HOMES**

8729 Whiteclover Street

LITTLETON, CO 80125

GET IN TOUCH
(720) 704-1472

DUETS AT STERLING RANCH BY TRUMARK HOMES | PLAN 2

