

# 258 Memphis Belle Way

SAN LUIS OBISPO, CA 93401



PRICE  
**\$918,795**

PLAN  
Plan 2

LOCATION  
Islay at Avila Ranch

## FEATURES

-  3 Bedrooms
-  2 Ba, 1 Half Ba
-  1,609 Sq. Ft.
-  1 Car Garage

Homesite 306 is the Islay Plan 2 at Avila Ranch, a modern floorplan to fit your family's unique needs. Upon entry, you are greeted by the stairway and a spacious storage closet. The entryway flows into the kitchen with a powder bathroom at the end of the hall for added convenience. The floor plan opens into the kitchen, dining space, and Great Room. With these spaces seamlessly connected, hosting gatherings is a breeze. The kitchen boasts a large center island and ample counterspace, while the Great Room has access to the back porch and large windows to allow natural light. Upstairs, you are first greeted by the laundry room and Bedrooms 2 and 3. The other side of the floor boasts a full bathroom and the Owner's Suite. The Owner's Suite has an en-suite bathroom with two walk-in closets and a dual sink vanity.



# 258 Memphis Belle Way

SAN LUIS OBISPO, CA 93401



1ST FLOOR

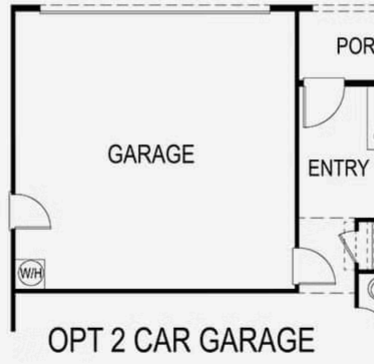

OPT 2 CAR GARAGE

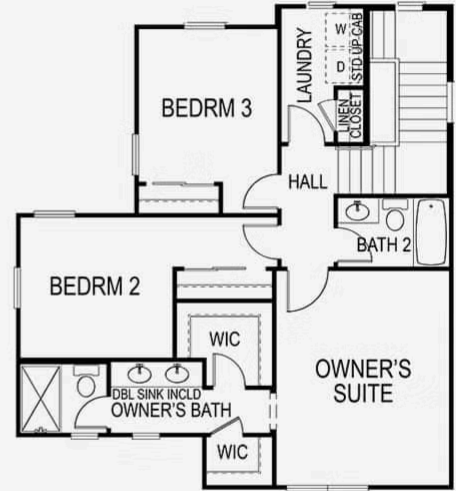

2ND FLOOR