

256 Memphis Belle Way

SAN LUIS OBISPO, CA 93401



PRICE
\$916,725

PLAN
Plan 2

LOCATION
Islay at Avila Ranch

FEATURES

-  3 Bedrooms
-  2 Ba, 1 Half Ba
-  1,609 Sq. Ft.
-  1 Car Garage

Homesite 305 is the Islay Plan 2 at Avila Ranch, a brilliant two-story home that features an open design and plenty of room for the family. The first floor beckons with an inviting entryway leading to a spacious kitchen and dining space. Before the entryway ends, there is a powder bathroom and storage closet for added convenience and functionality. The kitchen boasts a center island and ample countertop space, inviting culinary creativity. The dining space is an ideal spot for everyday family meals and hosting gatherings, flowing seamlessly into the Great Room. Upstairs, the owner's suite, a tranquil enclave on this level, boasts a private bathroom and two walk-in closets, ensuring a restful retreat. Two additional bedrooms provide comfortable accommodations for guests. A well-placed bathroom serves these bedrooms, maintaining privacy and convenience. The practical design is further emphasized by the inclusion of a laundry room making household chores effortless.

256 Memphis Belle Way

SAN LUIS OBISPO, CA 93401



1ST FLOOR

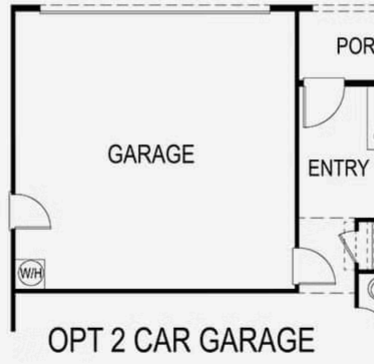

OPT 2 CAR GARAGE

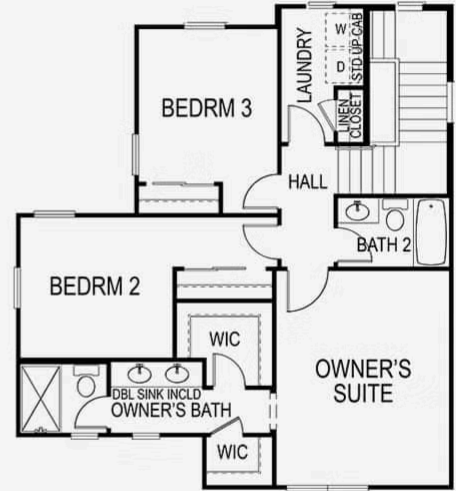

2ND FLOOR