

# 230 Memphis Belle Way

SAN LUIS OBISPO, CA 93401



PRICE  
**\$899,990**

PLAN  
Plan 2

LOCATION  
Islay at Avila Ranch

## FEATURES

-  3 Bedrooms
-  2 Ba, 1 Half Ba
-  1,609 Sq. Ft.
-  2 Car Garage

Homesite 291 is the Islay Plan 2 at Avila Ranch, a brilliant two-story home that features an open design and plenty of room for the family. The first floor welcomes you with an inviting entryway leading to a spacious great room, a versatile space perfect for entertainment and relaxation. Adjacent to the great room is a kitchen equipped with modern appliances, a center preparation island, pantry for storage, and access to a charming porch ideal for outdoor dining or morning coffee. Located within walking distance of a future park, this home also includes stainless steel appliances such as a stovetop and dishwasher. Upstairs, the Owner's Suite offers a tranquil retreat with a private bathroom and two walk-in closets. Two additional bedrooms provide comfortable accommodations for guests, supported by a well-placed bathroom that maintains privacy and convenience. A laundry room with upper cabinets adds practicality to the design, making household chores effortless. The Islay Plan 2 is thoughtfully crafted to support modern living with comfort and style.

REPRESENTATIVE PHOTOS ADDED



# 230 Memphis Belle Way

SAN LUIS OBISPO, CA 93401



1ST FLOOR

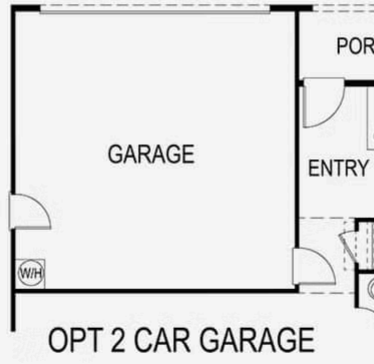

OPT 2 CAR GARAGE

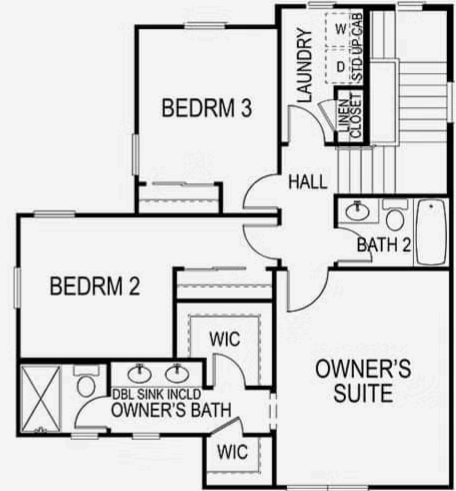

2ND FLOOR