

Plan 6

SADDLEBACK PLACE

**PRICE**
\$965,900**FEATURES**

-  3 Bedrooms
-  3 Bathrooms
-  1,694 Sq. Ft.
-  2 Car Garage

There's a lot to love with Plan 6's beautifully designed three-story floor plan offering 1,694 sq. ft. of beautiful living space. A two-car garage connects to a convenient first-floor flex room. Head to the second floor and take in the expansive great room, which flows into the dining room and kitchen. The gourmet kitchen is complete with a pantry and bar-top island with dual sinks that overlook the main living area. The kitchen includes full overlay, frameless flat panel contemporary maple cabinetry with knobs, quartz slab kitchen countertops with your color choice of 6" backsplash, and stainless steel premium kitchen appliance package.

Best of all, a third staircase elevates you to the primary bedroom – a private suite complete with an adjoining bathroom and generous walk-in closet. The stunning, spa-like bathroom features dual sinks and generously sized walk-in shower. This floor also includes a secondary bedroom with an adjoining bathroom and walk-in closet.

[View Community Brochure](#)

Plan 6

SADDLEBACK PLACE

GET IN TOUCH
(925) 281-3227

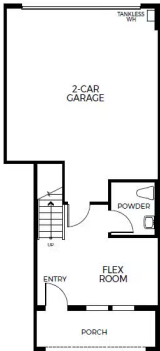

Plan 6

SADDLEBACK PLACE

GET IN TOUCH
(925) 281-3227

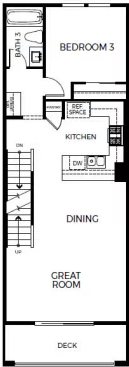

Plan 6

SADDLEBACK PLACE

GET IN TOUCH
(925) 281-3227

