

1325 Crescent Ave

MANTECA, CA 95336



PRICE
\$593,186

PLAN
Residence 3

LOCATION
Dawn at The Collective 55+

FEATURES
🛏 2 Bedrooms
🚿 2 Ba, 1 Half Ba
📏 2,462 Sq. Ft.
🚗 2 Car Garage

Homesite 285 at Dawn at The Collective by Trumark Homes is a flexible single-story home offering 2,462 Sq. Ft. of living space that is move-in ready!

This home features stylish Dove Gray cabinets accented by Satin Nickel hardware pulls, complemented by upgraded kitchen countertops with a full backsplash. A mix of laminate, tile, and carpet flooring adds both comfort and durability throughout the living spaces. Enjoy outdoor living with a covered patio, and find flexibility with French doors at the den, offering added style and privacy. Whirlpool stainless steel appliances are also included, combining function and modern appeal.

A secondary bedroom and den are included off the front of the home. Beyond the entrance hall is the kitchen, featuring a walk-in pantry and spacious center preparation island overlooking the expansive great room and dining area. The primary suite offers a bathroom with dual sinks, walk-in shower, and a bathtub. A walk-in closet completes the primary suite.

Schedule your appointment now to make this home yours!

*Representative photos added.

DAWN AT THE COLLECTIVE | RESIDENCE 3 FLOOR PLAN

Dawn
AT THE COLLECTIVE

RESIDENCE 1
2 Bedrooms, 2.5 Baths, 2,021 Sq. Ft.



IAR - Contemporary Farmhouse



IBR - Napa Valley Classic



ICR - Craftsman



ELEVATION 1CR



OPTIONAL COVERED
OUTDOOR ROOM

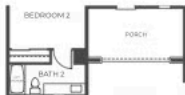

ELEVATION IAR



ELEVATION IBR

New Home Specialist • (925) 281-3227 • Sales@TrumarkHomes.com
Dawn Sales Gallery • 1306 Parkcrest Circle, Manteca, CA 95336 • VIP-Dawn.com

This is not an offer to sell but is intended for information only. The developer reserves the right to make modifications to materials, specifications, plans, pricing, various fees, designs, scheduling and delivery of homes without prior notice. Square footage is approximate. Floor plans are for representational purposes only. Plans and dimensions may contain minor variations from floor to floor. Renderings are artist's conceptions and do not depict actual homesites. CA CRE license #0187729, 8/2022.

PRELIMINARY AND SUBJECT TO CHANGE

TRUMARKHOMES