

# 1084 Kestrel Street

MANTECA, CA 95336



PRICE  
**\$617,129**

PLAN  
Residence 2

LOCATION  
Dawn at The Collective 55+

## FEATURES

-  2 Bedrooms
-  2.5 Bathrooms
-  2,314 Sq. Ft.
-  2 Car Garage

Homesite 292 at Dawn at The Collective by Trumark Homes is a flexible single-story home offering 2,314 Sq. Ft. of living space with two bedrooms and two and a half bathrooms that is Move-in ready! Key features include solar system and backup battery, outdoor covered CA room, over \$115,000 in designer upgrades, GE stainless steel kitchen appliance package, and \$20,000 preferred lender credit for limited time!

The plan features an inviting entryway with an optional portico and courtyard. To the right, off the entry opposite to the kitchen is the hall to the guest powder room, laundry room, well-sized den, and guest quarters featuring an impressive walk-in closet and full bathroom. Past the entryway is the gourmet kitchen, featuring a spacious walk-in pantry and a center preparation island. This island overlooks the expansive dining and great rooms. The kitchen includes recessed-panel Beech Shaker cabinetry, chrome knobs, and granite slab countertops with 6" backsplash. The primary suite offers a contemporary, spa-like bathroom with dual sinks, a walk-in shower, and a spacious bathtub. Connected to the bathroom is an expansive walk-in closet to complete the primary suite. This home also features luxury vinyl plank flooring at entry, kitchen, laundry, and bathrooms, Kohler plumbing features, and much more!

REPRESENTATIVE PHOTOS ADDED.



DAWN AT THE COLLECTIVE | RESIDENCE 2 FLOOR PLAN

**Dawn** | RESIDENCE 1  
AT THE COLLECTIVE | 2 Bedrooms, 2.5 Baths, 2,021 Sq. Ft.

THE COLLECTIVE  
TRULIVING MANTECA



IAR - Contemporary Farmhouse



IBR - Napa Valley Classic



ICR - Craftsman



ELEVATION ICR



OPTIONAL COVERED OUTDOOR ROOM

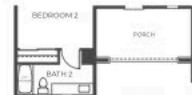

ELEVATION IAR



ELEVATION IBR

New Home Specialist • (925) 281-3227 • Sales@TrumarkHomes.com  
Dawn Sales Gallery • 1306 Parkcrest Circle, Manteca, CA 95336 • VIP-Dawn.com

This is not an offer to sell but is intended for information only. The developer reserves the right to make modifications to materials, specifications, plans, pricing, various fees, designs, scheduling and delivery of homes without prior notice. Square footage is approximate. Floor plans are for representational purposes only. Plans and dimensions may contain minor variations from floor to floor. Renderings are artist's conceptions and do not depict actual homesites. CA CRE license #0167729, 8/2022.

PRELIMINARY AND SUBJECT TO CHANGE

TRUMARKHOMES