

# Plan 6

FLATS & TOWNS AT ZEST



PRICE  
**\$700,400**

## FEATURES

-  3 Bedrooms
-  3.5 Bathrooms
-  1,629 Sq. Ft.
-  2 Car Garage
-  1 Flex

There's a lot to love with Plan 6's beautifully designed three-story floor plan offering 1,629 sq. ft. of beautiful living space. A two-car garage connects to a convenient first-floor flex room. Head to the second floor and take in the expansive great room, which flows into the dining room and kitchen. The gourmet kitchen is complete with a pantry and bar-top island with dual sinks that overlook the main living area. The kitchen includes full overlay, frameless flat panel contemporary maple cabinetry with knobs, granite slab kitchen countertops with your color choice of 6" backsplash, and GE stainless steel premium kitchen appliance package.

Best of all, a third staircase elevates you to the primary bedroom – a private suite complete with an adjoining bathroom and generous walk-in closet. The stunning, spa-like bathroom features dual sinks and generously sized walk-in shower. This floor also includes a secondary bedroom with an adjoining bathroom and walk-in closet. This plan comes with your color choice of Welcoming tile at entry, kitchen, bathrooms and laundry, Kohler plumbing features, and much more!



# Plan 6

FLATS & TOWNS AT ZEST

## ZEST PLAN 6 FLOOR PLAN

PRELIMINARY



### FLATS & TOWNS - PLAN 6

Three-Story | Approx. 1,629 Sq. Ft.  
3 Bedrooms + Flex Room | 3.5 Bathrooms | 2-Car Garage

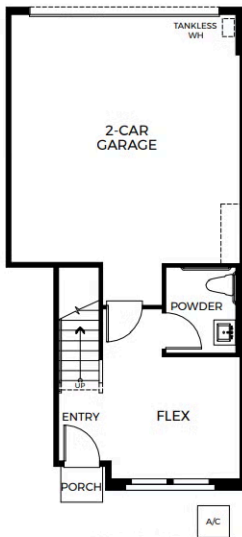

FIRST FLOOR

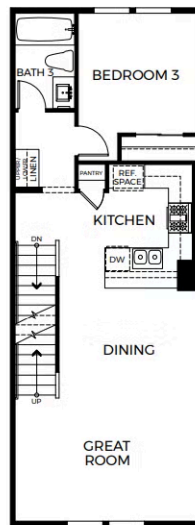

SECOND FLOOR

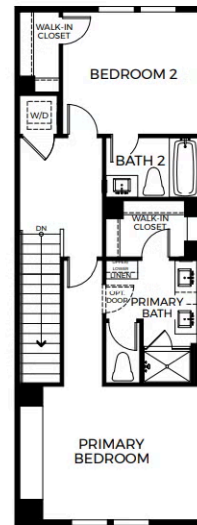

THIRD FLOOR