

1346 Alyssa Drive

TIMNATH, CO 80547



PRICE

\$925,312

PLAN

Plan 3

LOCATION

Kitchel Lake

FEATURES

-  4 Bedrooms
-  3.0 Bathrooms
-  2,768 Sq. Ft.
-  4 Car Garage

REPRESENTATIVE PHOTOS ADDED. Lot 6, a Plan 3 at Kitchel Lake, features a 4-car tandem garage off the front of the home. The expansive two-story plan offers up to 3,733 Sq. Ft. of living space with four bedrooms and three baths. Beyond the entrance hall is the gourmet kitchen featuring a spacious walk-in pantry and a center preparation island. This island overlooks the open-ceiling dining room and the great room, complete with a gas fireplace. The extended gourmet kitchen includes 42" light-stained cabinetry, Quartz countertops with tile backsplash, stainless steel appliance package with a 5-burner gas cooktop, a convection oven, a built-in microwave, and a dishwasher. This room conveniently connects to the office and the covered outdoor room.

Upstairs, you'll find a bonus room and two secondary bedrooms connected by an ensuite bathroom with dual sinks. The upstairs primary suite offers a luxurious, spa-like bathroom with a walk-in shower, a freestanding tub and an expansive walk-in closet. The home comes with water-resistant 5" engineered plank flooring, deluxe primary shower tile with mosaic tile shower pan, spacious 9 or 10-foot ceilings, insulated steel garage door, tankless water heater and AC, and much more!

KITCHEL LAKE PLAN 3 FLOOR PLAN



PLAN 3 - OPTIONS

4 - 6 Bedrooms - 3 - 4 Baths - 4-Car Garage (Tandem)
2768 - 3733 Finished Sq. Ft.

PRELIMINARY

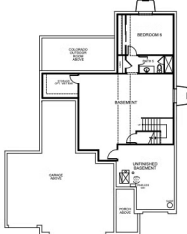

BASEMENT OPTION 3



All information is for reference only. Prices, fees and specifications subject to change and should be verified by all potential homebuyers. This is not an offer to sell but is intended for information only. The developer reserves the right to make modifications in materials, specifications, plans, pricing, without fees, designs, scheduling and delivery of homes without prior notice. All dimensions and square footages are approximate. Plan and dimensions may contain minor variations from floor to floor. Call 970.499.8222 for more information. ©2017/2018

VIP-KITCHEL.COM

KITCHEL LAKE PLAN 3 FLOOR PLAN



PLAN 3 - OPTIONS

4 - 6 Bedrooms • 3 - 4 Baths • 4-Car Garage (Tandem)
2,766 - 3,753 Finished Sq. Ft.

PRELIMINARY

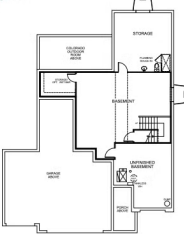

BASEMENT OPTION 1

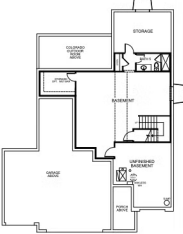

BASEMENT OPTION 2



All information is for reference only. Prices, fees and specifications subject to change and should be verified by all potential homebuyers. This is not an offer to sell but is intended for information only. The developer reserves the right to make modifications in materials, specifications, plans, pricing, features, design, scheduling and delivery of homes without prior notice. All dimensions and square footages are approximate. Plan and dimensions may contain minor variations from floor to floor. CA 026 Compliance 08/07/22. ©

[VIP-KITCHEL.COM](http://vip-kitchel.com)

KITCHEL LAKE PLAN 3 FLOOR PLAN

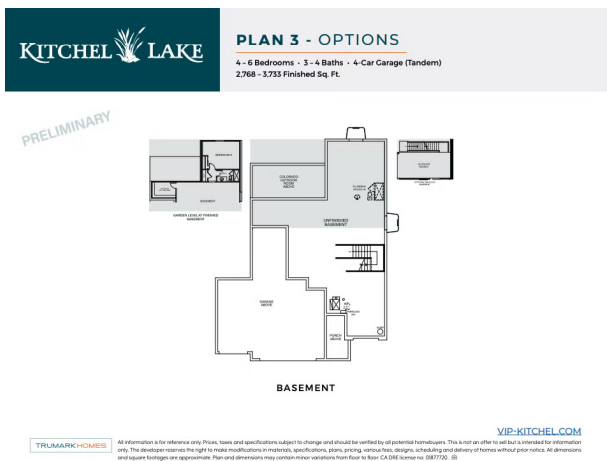

TRUMARKHOMES

1346 Alyssa Drive

TIMNATH, CO 80547

GET IN TOUCH
(970) 499-8222

KITCHEL LAKE PLAN 3 FLOOR PLAN



TRUMARKHOMES

1346 Alyssa Drive

TIMNATH, CO 80547

GET IN TOUCH
(970) 499-8222

KITCHEL LAKE PLAN 3 FLOOR PLAN



TRUMARKHOMES

1346 Alyssa Drive

TIMNATH, CO 80547

GET IN TOUCH
(970) 499-8222

KITCHEL LAKE PLAN 3 FLOOR PLAN

